

**COBBLESTONE REC 60MM**

PRODUCT NUMBER # 437



- Deeply rounded surfaces combine to create the enduring appeal of stone cobbles formed by glaciers and set by hand
- Barreled sidewalls are ideal for decorative curvilinear laying patterns such as fans and circles
- Made of durable concrete with iron oxide pigments which helps prevent fading from extended UV exposure. Meets or exceeds applicable requirements of ASTM C936 and C1782.
- Light vehicular applications

The CobbleStone series features rounded shapes, surfaces, and edges which recall the timeless appeal of stones worn smooth by glaciers. CobbleStone pavers may be installed in efficient random runner and ashlar patterns, but the barreled sides of CobbleStone - also available in a Circle Pack - make it particularly well-suited for decorative curvilinear installations to create the aesthetic of historical Old World pavements.

**STONE(S)**

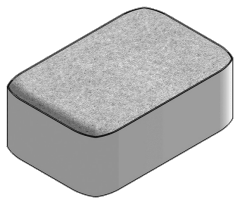

		Rec
<b>Height</b>	<i>in</i>	2.36
	<i>mm</i>	60
<b>Length</b>	<i>in</i>	6.77
	<i>mm</i>	172
<b>Width</b>	<i>in</i>	4.53
	<i>mm</i>	115
<b>Units</b>	<i>/pl</i>	490

**PALLET LAYOUT**

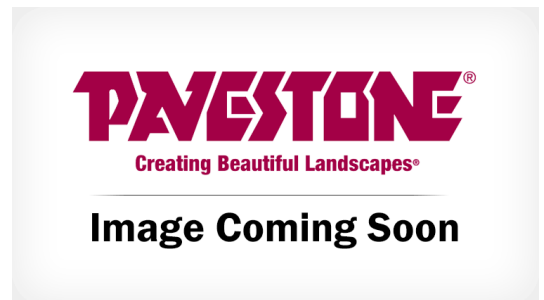

**NOTES**

Weights are approximate and do not include shipping pallet.

**PALLET SPECS**

<b>Pallet Weight</b>	2884 lbs
<b>Sq Ft/Pallet</b>	103 sq.ft.