

12IN RETAINING WALL

PRODUCT NUMBER # 811



- Hard split showcases fractured rock and the veining and contrast of blended colors
- Rear lips ensure precise setback and eliminate the material and labor costs of connectors
- Hard split showcases fractured rock and the veining and contrast of blended colors
- Made of durable concrete that does not attract pests and is resistant to decay and fading

Choose the natural elegance and long-lasting beauty of a concrete garden wall block for your next landscape creation. The perfect complement to residential landscape design, these low-maintenance and easy-to-install stones are a beautiful solution for any project from garden beds and tree rings to curved walls and terraces. Environmentally friendly and attractive, these retaining walls flow naturally with your landscape's contours.

STONE(S)

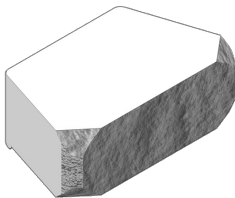

		Wall
Height	<i>in</i>	4
	<i>mm</i>	101.6
Length	<i>in</i>	6.75
	<i>mm</i>	171.5
Width	<i>in</i>	11.63
	<i>mm</i>	295.3
Units	<i>/pl</i>	144

PALLET LAYOUT

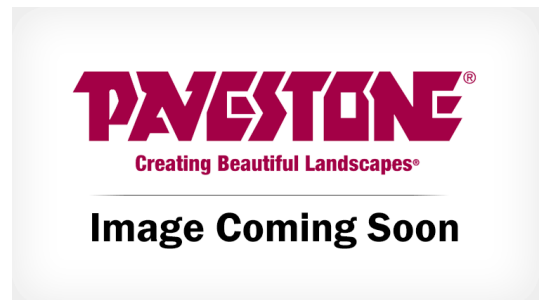

NOTES

Weights are approximate and do not include shipping pallet.

PALLET SPECS

Pallet Weight	3114 lbs
Sq Ft/Pallet	46.6 sq.ft.